

4988

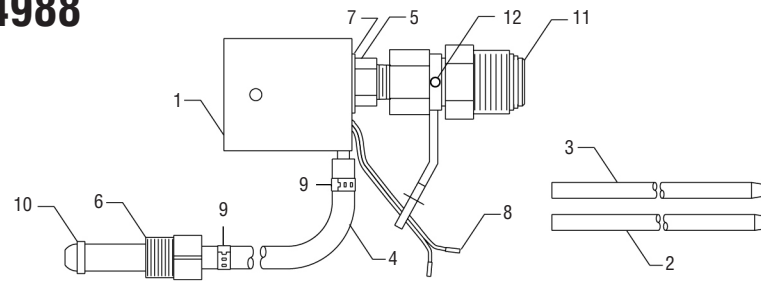

FOR USE ON		ITEM	PART NO.	DESCRIPTION
Airco AHF-N,		1	4893	Body, w/Gas Barb & O-Ring
AHF-R, AHF-S,		2	4953	Guide Tube, Small I.D.
AHF-T, AHF-U,		3	4963	Guide Tube, Large I.D.
AHF-V, AHF-J,		4	1571	Gas Hose
AHF-L, AHF-W		5	4908	Socket
(W/pre-cut guide tubes)		6	1566	Gas Nut
		7	4912	Snap Ring
		8	4942	Wire Assembly
		9	4991	Oetiker Clamp
		10	663	Hose Gland
		11	4825	Adaptor Body
		12	396	Set Screw

4995

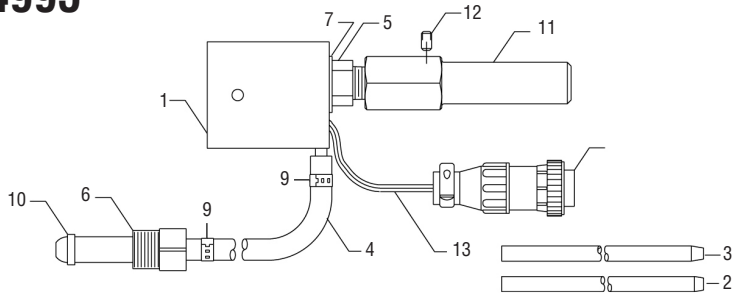

FOR USE ON		ITEM	PART NO.	DESCRIPTION
Miller 542 GL		1	4893	Body, w/Gas Barb & O-Ring
Swing Arc, part 079-548		2	4958	Guide Tube, Small I.D.
Porta-MIG		3	4968	Guide Tube, Large I.D.
Millermatic 40, 50		4	1571	Gas Hose
Migmate		5	4908	Socket
Millermatic 130		6	1566	Gas Nut
Miller S-32S & S-32P		7	4912	Snap Ring
		8	4996	Lead Assembly (includes 4942)
W/pre-cut guide tubes and plugs		9	4991	Oetiker Clamp
		10	663	Hose Gland
		11	1294	Adaptor Body
		12	396	Set Screw
		13	4942	Wire Assembly

INSTALLATION INSTRUCTIONS

- Quick Disconnect Feeder End may be connected directly to a Bernard adaptor by threading quick disconnect directly into adaptor. Make all necessary power, control, and gas connections.
- Quick Disconnect Feeder End, PN 4920 is supplied with two long guide tubes (PN 478 and 479) of different I.D.'s which must be cut to the proper length.
- Select the proper guide tube I.D. from the table below.
 - .023-.052 Electrode Small I.D.
 - .062-1/8 Electrode Large I.D.
- Install taper end toward feed rolls. If electrodes below .045 are being used, it may be advisable to grind a chisel point on the tapered end to guide electrode closer to the feed rolls.
- Procedure to determine cut length for guide tube that extends beyond quick disconnect (Refer to Illustration 1):
 - A. Mark tube at point even with end of quick disconnect body.
 - B. Remove guide tube.

QUICK DISCONNECT FEEDER END ADAPTOR KITS 4820G - 4995

- C. Cut guide tube at a point 1-1/2" toward the taper from the area marked.
 - D. Reinstall in adaptor and tighten set screw.
- Procedure to determine cut length for guide tube recessed within quick disconnect (Refer to Illustration 2).
 - A. With small rule, measure amount guide tube is within quick disconnect body.
 - B. Using formula below, cut guide tube to proper length. Shorten guide tube from end opposite taper.
 - C. 1-1/2" minus distance measured inside the quick disconnect body equals length to be shortened.
 - Insert the guide tube in the adaptor. Check guide tube length as indicated in Illustration 3 for proper fit and tighten set screw. E-Z Feed Adaptor Kits are supplied with pre-cut guide tubes for specific machines, as indicated below.

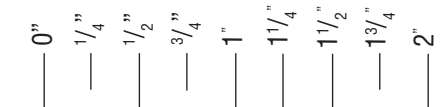
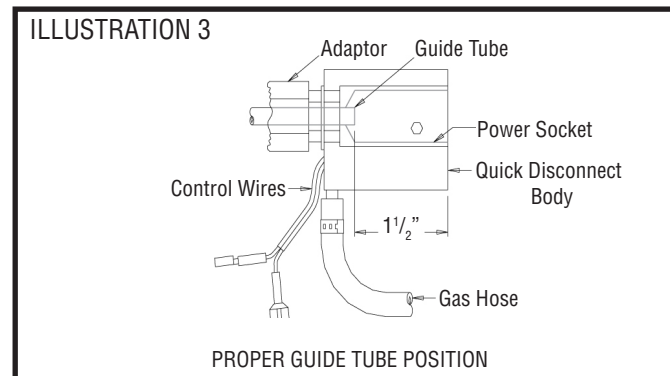
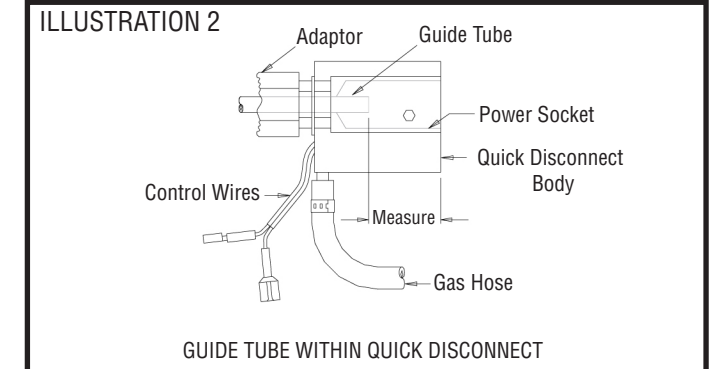
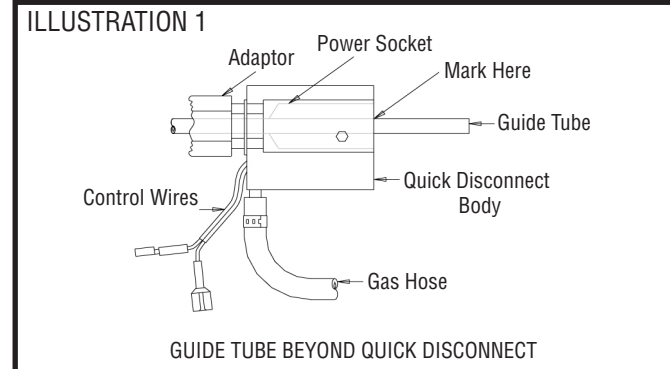

4820G

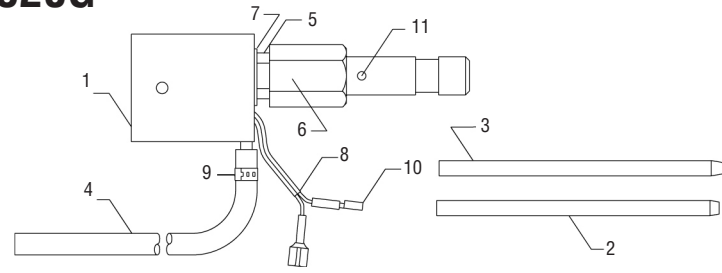

FOR USE ON	ITEM	PART NO.	DESCRIPTION
Hobart	1	4893	Body, w/Gas Barb & O-Ring
Beta-Mig	2	4850	Guide Tube, Small I.D.
200-2000	3	373	Guide Tube, Large I.D.
Models 17 & 19	4	1571	Gas Hose
	5	4908	Socket
Miller	6	5108	Adaptor Body
Migman 105	7	4912	Snap Ring
W/pre-cut guide tubes	8	4942	Wire Assembly
	9	4991	Oetiker Clamp
	10	1346	Terminals
	11	396	Set Screw

4820N

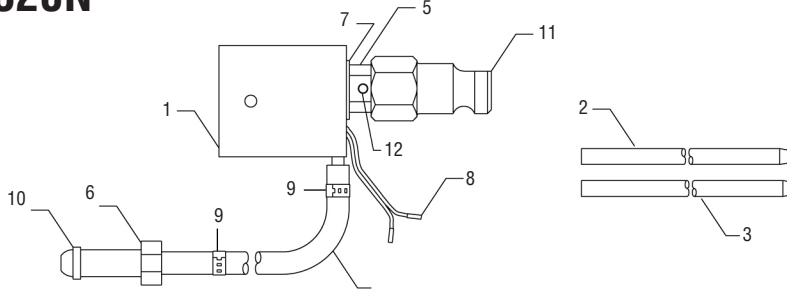

FOR USE ON	ITEM	PART NO.	DESCRIPTION
Panasonic YW501FK	1	4893	Body, w/Gas Barb & O-Ring
	2	4958	Guide Tube, Small I.D.
	3	379	Guide Tube, Large I.D.
National most models	4	1571	Gas Hose
	5	4972	Socket
	6	366	Gas Nut
	7	4912	Snap Ring
	8	4942	Wire Assembly
	9	4991	Oetiker Clamp
	10	663	Hose Gland
	11	7115	Adaptor Body
	12	396	Set Screw

4820P

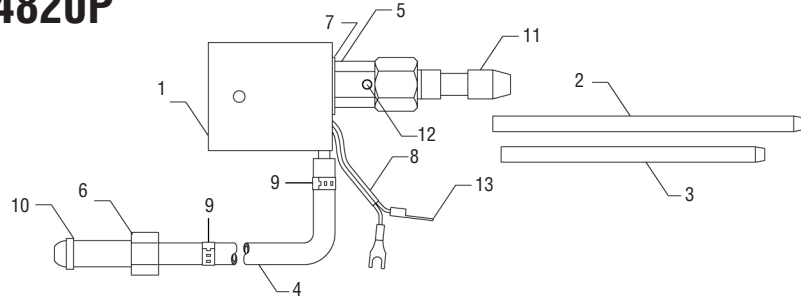

FOR USE ON	ITEM	PART NO.	DESCRIPTION
OTC most models	1	4893	Body, w/Gas Barb & O-Ring
	2	4958	Guide Tube, Small I.D.
	3	379	Guide Tube, Large I.D.
Gelco all models	4	1571	Gas Hose
	5	4972	Socket
	6	366	Gas Nut
	7	4912	Snap Ring
	8	4942	Wire Assembly
	9	4991	Oetiker Clamp
	10	663	Hose Gland
	11	7124	Adaptor Body
	12	396	Set Screw
	13	4261	Spade Terminal

4920

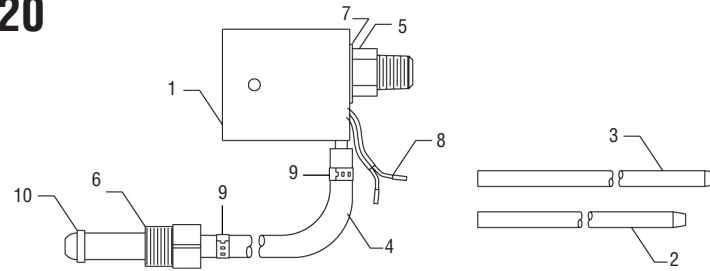

FOR USE ON	ITEM	PART NO.	DESCRIPTION
Quick Disconnect, feeder end w/guide tubes (2)	1	4893	Body, w/Gas Barb & O-Ring
Fits all existing Bernard adaptors	2	478	Guide Tube, Small I.D.
	3	479	Guide Tube, Large I.D.
	4	1571	Gas Hose
	5	4908	Socket
	6	1566	Gas Nut
	7	4912	Snap Ring
	8	4942	Wire Assembly
	9	4991	Oetiker Clamp
	10	663	Hose Gland

4970

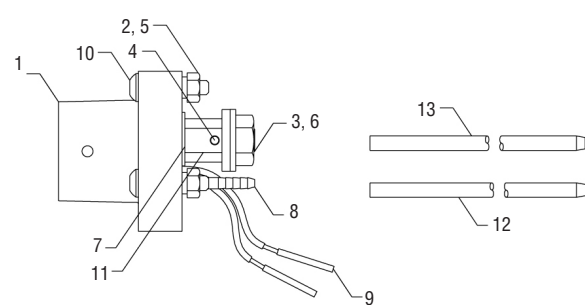

FOR USE ON	ITEM	PART NO.	DESCRIPTION
ESAB, most models	1	4971	Feeder Mount
	2	1456	Hex Nut
W/pre-cut guide tubes	3	4974	Hex Jam Nut
	4	396	Set Screw
	5	3613	Lock Washer
	6	4975	Flat Washer
	7	4912	Snap Ring
	8	4214	Gas Barb Assy. (w/4907 O-Ring)
	9	4942	Wire Assembly
	10	4973	Button Head Screw
	11	4972	Power Socket
	12	478	Guide Tube, Small I.D.
	13	479	Guide Tube, Large I.D.

4970A

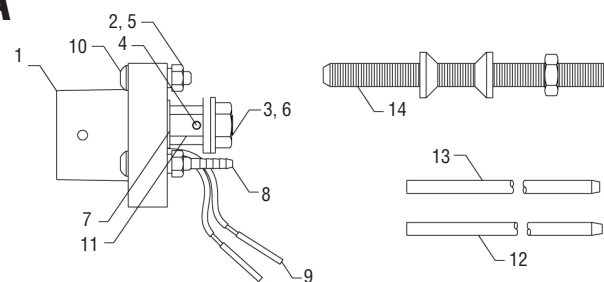

FOR USE ON	ITEM	PART NO.	DESCRIPTION
Universal flange mount quick disconnect	1	4971	Feeder Mount
	2	1456	Hex Nut
	3	4974	Hex Jam Nut
	4	396	Set Screw
	5	3613	Lock Washer
	6	4975	Flat Washer
	7	4912	Snap Ring
includes universal centering device for most European feeders	8	4214	Gas Barb Assy. (w/4907 O-Ring)
	9	4942	Wire Assembly
	10	4973	Button Head Screw
	11	4972	Power Socket
	12	478	Guide Tube, Small I.D.
	13	479	Guide Tube, Large I.D.
	14	4989	Centering Kit Complete

4981

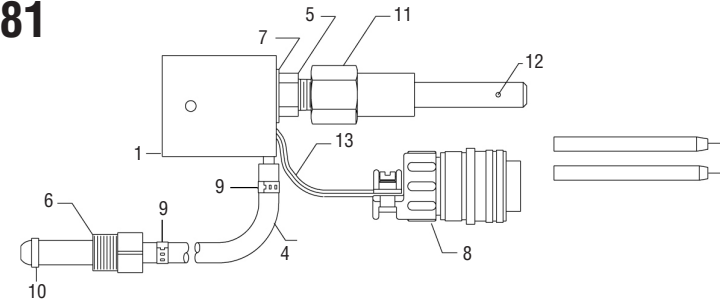

FOR USE ON	ITEM	PART NO.	DESCRIPTION
Lincoln LN4, LN-5, LN-6, LN-8, LN-9	1	4893	Body, w/Gas Barb & O-Ring
	2	4951	Guide Tube, Small I.D.
	3	4961	Guide Tube, Large I.D.
W/pre-cut guide tubes and plugs	4	1571	Gas Hose
	5	4908	Socket
	6	1566	Gas Nut
	7	4912	Snap Ring
	8	1694	Lead Set (Includes 4942)
	9	4991	Oetiker Clamp
	10	663	Hose Gland
	11	1381	Adaptor Body
	12	1384	Set Screw
	13	4942	Wire Assembly

4982

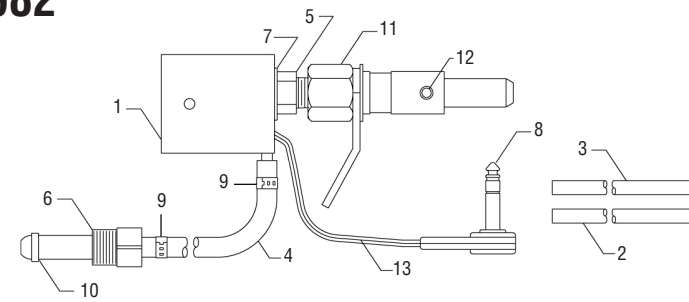

FOR USE ON	ITEM	PART NO.	DESCRIPTION
Hobart, all models except 200	1	4893	Body, w/Gas Barb & O-Ring
	2	4952	Guide Tube, Small I.D.
	3	4962	Guide Tube, Large I.D.
W/pre-cut guide tubes and plug	4	1571	Gas Hose
	5	4908	Socket
	6	1566	Gas Nut
	7	4912	Snap Ring
	8	1692	Lead Set (Includes 4942)
	9	4991	Oetiker Clamp
	10	663	Hose Gland
	11	1362	Adaptor Body
	12	396	Set Screw
	13	4942	Wire Assembly

4983

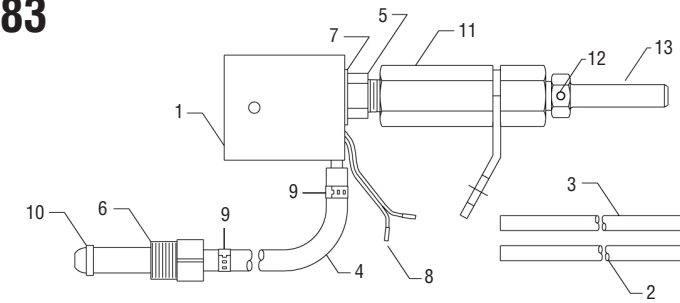

FOR USE ON	ITEM	PART NO.	DESCRIPTION
Miller, 10 & 30 Series 70 & 80 Series	1	4893	Body, w/Gas Barb & O-Ring
	2	4953	Guide Tube, Small I.D.
	3	4963	Guide Tube, Large I.D.
Machinery & Weldor MHFC-H, MHFC-R1	4	1571	Gas Hose
	5	4908	Socket
W/pre-cut guide tubes	6	1566	Gas Nut
	7	4912	Snap Ring
	8	4942	Wire Assembly
	9	4991	Oetiker Clamp
	10	663	Hose Gland
	11	1363	Adaptor Body
	12	396	Set Screw
	13	489	Adaptor Shank

4984

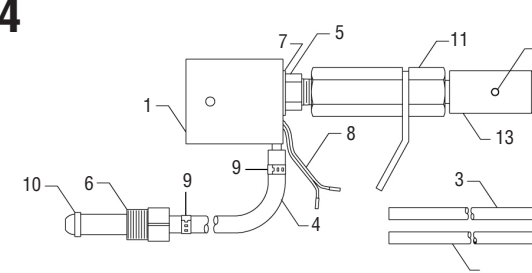

FOR USE ON	ITEM	PART NO.	DESCRIPTION
Linde, SWM-11, 11B, 23, 24, 25, 26, 35, SEH-3, SEH-5, SEH-10	1	4893	Body, w/Gas Barb & O-Ring
Digimig	2	4955	Guide Tube, Small I.D.
	3	4965	Guide Tube, Large I.D.
	4	1571	Gas Hose
	5	4908	Socket
W/pre-cut guide tubes	6	1566	Gas Nut
	7	4912	Snap Ring
	8	4942	Wire Assembly
	9	4991	Oetiker Clamp
	10	663	Hose Gland
	11	1363	Adaptor Body
	12	396	Set Screw
	13	1170	Adaptor Shank

4984B

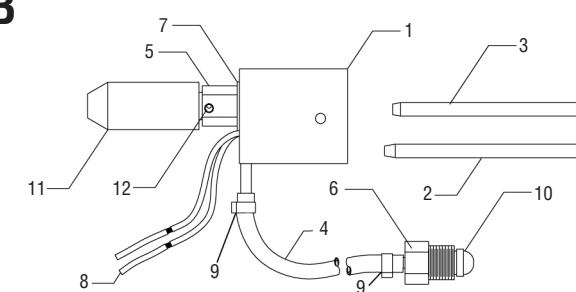

FOR USE ON	ITEM	PART NO.	DESCRIPTION
Linde	1	4893	Body, w/Barb & O-Ring
	2	4955	Guide Tube, Small I.D.
	3	4965	Guide Tube, Large I.D.
	4	1571	Gas Hose
	5	4972	Power Socket
	6	1566	Gas Nut
	7	4912	Snap Ring
	8	4942	Wire Assembly
	9	4991	Clamp
	10	663	Hose Gland
	11	1170A	Adaptor Shank
	12	396	Set Screw

4986

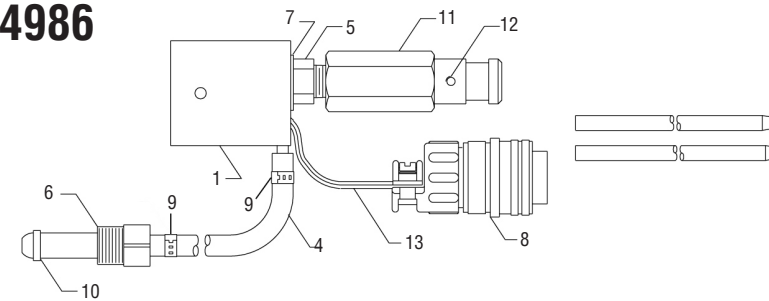

FOR USE ON	ITEM	PART NO.	DESCRIPTION
Lincoln LN-7, SP-200, LN-22	1	4893	Body, w/Gas Barb & O-Ring
	2	4956	Guide Tube, Small I.D.
	3	4966	Guide Tube, Large I.D.
W/pre-cut guide tubes and plug	4	1571	Gas Hose
	5	4908	Socket
	6	1566	Gas Nut
	7	4912	Snap Ring
	8	1694	Lead Assembly (includes 4942)
	9	4991	Oetiker Clamp
	10	663	Hose Gland
	11	295	Adaptor Body
	12	396	Set Screw
	13	4942	Wire Assembly